



TELFORD PLACE INDUSTRIAL LAND

65 Avenue & Range Road 247, Leduc, AB

FOR SALE

PROPERTY HIGHLIGHTS

- Located at Intersection of Future Spine Road & Highway 623 (Rollyview Road)
- Vendor Financing is Available
- East Telford Lake Area Structure Plan
- Highway Commercial and Industrial Land
- Vendor Willing to sell Smaller Portions of Land as little as 20 Acres (Purchase will be Responsible for Subdivision and Servicing Costs)

TELFORD LAKE INDUSTRIAL LANDS FOR SALE

PROPERTY INFORMATION

MUNICIPAL ADDRESS:	Rollyview Road & RR 247, Leduc, AB
LEGAL DESCRIPTION:	Plan 0526444 Block 1 Lot 2
SIZE:	122 Acres (+/-)
ZONING:	Future Highway Commercial and Industrial Land
POSSESSION:	Immediate/Negotiable
PURCHASE PRICE:	\$85,000/Acre

MORE INFORMATION

KARIM BENSALAH
ASSOCIATE

Cell: 780.729.4382
Direct: 780.784.5357
Fax: 780.483.2277
karim@lizotterealestate.com

City of Leduc has determined that these lands are ideally located for the following uses:

- Aerospace & Aviation
- Energy
- Agri-business
- Transportation, Logistics, & Distribution
- Information Communication Technology (ICT)
- Advanced Manufacturing
- Life Sciences
- Education

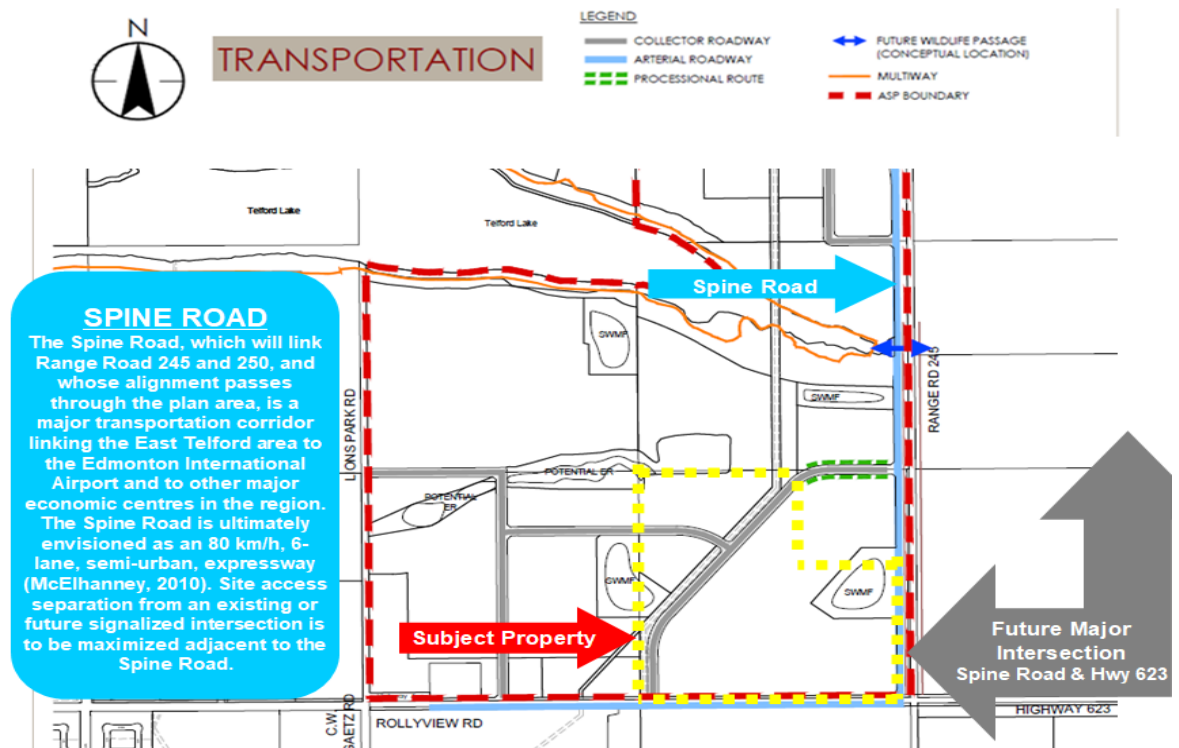

LIZOTTE
AND ASSOCIATES REAL ESTATE INC

780.488.0888

www.lizotterealestate.com

#1200, 10117 Jasper Avenue Edmonton, AB T5J 1W8

No warranty or representation, expressed or implied, is made as to the accuracy of the information contained herein, and same is submitted subject to errors, omissions, change of price, rental or other conditions, withdrawal without notice, and to any specific listing condition, imposed by our principals.